

# RZA

RĘCZNA  
ZGRZEWARKA  
AKUMULATOROWA



MANUAL ACCUMULATOR WELDER

**INSTRUCTION**  
with warranty

### **1.Welder's destiny.**

Manual accumulator welder RZA is used for connecting copper cable (for example graphite brushes) with copper or stainless steel and copper flat bar together. It has special appliance in the workshop while repairing vehicle electromechanical starters.

### **2.Instructions.**

To take full advantage of welders and ensure the safety, follow the following rules:

- 1) Sockets, which are on the end of the cables, should be connected to the accumulator (min. 45 Ah).
- 2) Clean materials, which are going to be connected, shall be placed between electrodes (steel and coal). Between materials should be a small amount of flux.
- 3) Pliers tight slightly.
- 4) Press footswitch button for about 2-3 seconds. During this time the flux will link those two metals.
- 5) Release the button, but the welding tongs keep still pressed until solidify flux.
- 6) The connection should be ready.

### **3.Basic errors in the work.**

- Too long turned on the power button.
- Not enough flux.
- Dirty steel electrode or material.

### **4.Safety rules.**

Because of the possibility of breakouts material during welding it is obligatory to use protective glasses while working.

### **5.Features.**

The RZA welding equipment includes:

- Sealing Pliers
- Connectors
- Footswitch
- Spare electrode
- The flux

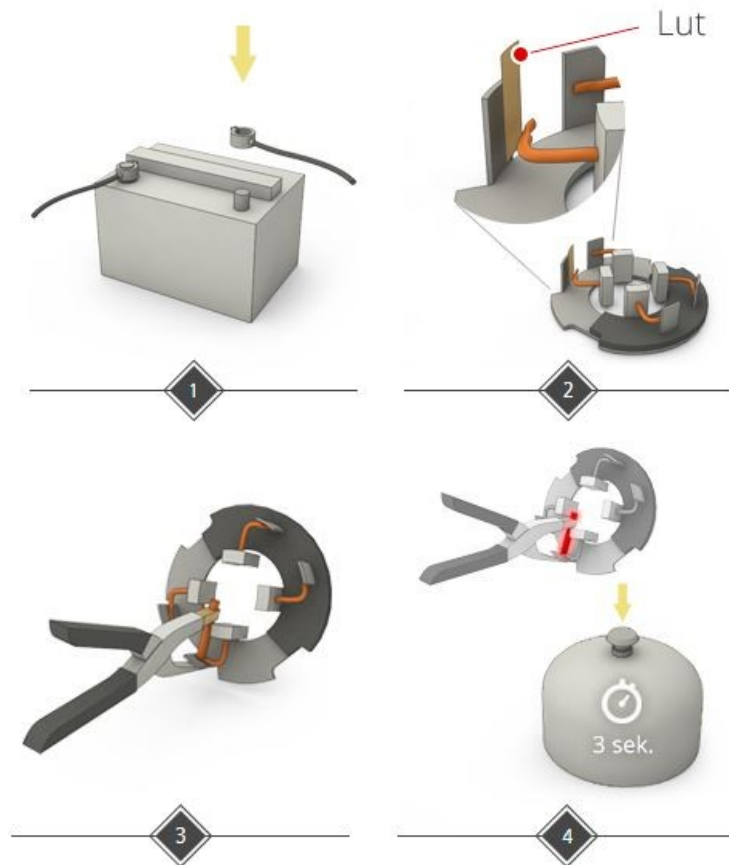

## Warranty

The manufacturer guarantees the good quality and efficient work of the product. The warranty period is 12 months from date of purchase, provided that the product is used according to the instructions and there was no repairs or alterations by unauthorized persons. Any defects discovered during the warranty period will be repaired free of charge within 14 days from the date of delivery of welding to the manufacturer.

The warranty does not cover mechanical damage and exhaustible parts such as electrodes.

**WARNING! Design registered in the Polish Patent No. 112088**



Producer:

**FIGEL Auto Narzędzia**  
ul. Chrzanowskiego 36A  
80-278 Gdańsk  
Tel. (58) 341 04 53  
Poland